



Model: See Affected Units

Serial #: N/A

Jul. 18, 2025

Product Bulletin # CDS-015 Rev 1

Alert



External Casing Drive System (ECDS) Pins & Links Failure when Standard Mk3 Actuator Apply Pressure is Exceeded

Issue At Hand

The standard CDS Mk3 Actuator Apply Pressure is 2,000 psi for Casing-Running operations and 1,400 psi for Casing-While-Drilling operations.

At times, an increased CDS Mk3 Actuator Apply Pressure of 2,500 psi is used to attain higher torque transfers.

It came to Canrig's attention that Casing-Running operations with ECDS tools have shown failure of Link Pins, Slip Links and Push/Pull Collars while CDS Mk3 Actuator Apply Pressure has been increased to 3,000 psi. See Figure 1 on page 2.

In the situation where the dies are not engaged with the casing, there is the potential to drop a Slip Assembly. Refer to Figure 1 on page 2.

Affected Units

The affected CDS External Drives are:

- Drive, External, 2-7/8" to 7" Casing, ECDS – Canrig P/N: 720632
- Drive, External, 7" to 8 -5/8" Casing, ECDS – Canrig P/N: 720635

The affected CDS External Drives components are:

- Link Pins – Canrig P/N: 15802
- Slip Links – Canrig P/N: 15693
- Push/Pull Collar – Canrig P/N: 15691 for 2-7/8" to 7" ECDS (or Caring P/N: 17183 for 7" to 8-5/8" ECDS)

The Link Pins may get damaged when the CDS Mk3 Actuator Apply Pressure exceeds 2,500 psi. Also, the holes of the Slip Links and Push/Pull Collars may get elongated and out of tolerance, reducing performance and reliability.



Model: See Affected Units

Serial #: N/A

Jul. 18, 2025

Alert

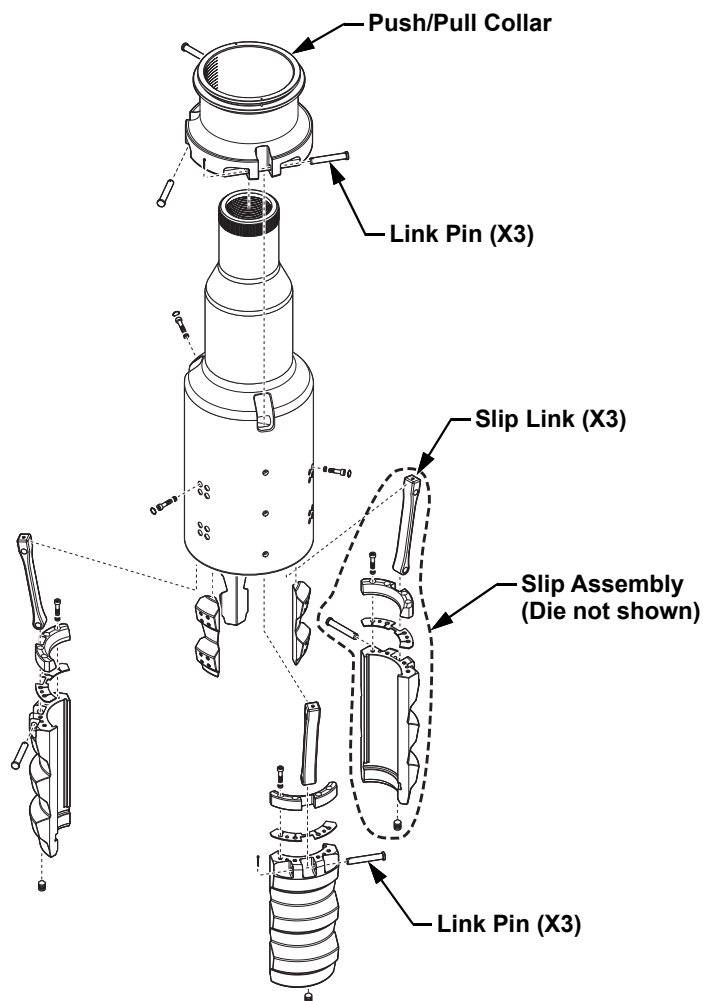

Figure 1: ECDS Drive

Recommended Actions

- Do not operate above an Mk3 Actuator Apply Pressure of 2,500 psi.
- Frequently monitor the Link Pins during the casing run.
- Inspect and ensure the integrity of the Link Pins, Slip Links and Push/Pull Collars during shop redressing and regular maintenance. Look for Link Pins bends and cracks; Look for Slip Links and Push/Pull Collars holes, elongations, and other damage.