



Model: CDS
Serial #: N/A

Sep. 12, 2024

Product Bulletin # CDS-012 Rev 1

Replacement of Coupler Plate Mount with Brace for CDS Link Tilt Operations With Stabilizer Kit

Issue

A dropped object incident occurred involving a trunnion #5104016, a component of Single Joint Links Stabilizer Kit #5104015. The Trunnion was installed with inadequate length bolts while a #DT24294 Coupler Plate Mount was also present on the CDS Link Tilt Assembly. The Coupler Plate Mount accessory #DT24294 was not taken in consideration at the time of SJ Links Stabilizer Kit design.

No personnel have been hurt.

The components subject to this bulletin are:

Part #	Description
5104015	Kit, Stabilizer, Single Joint Links, CDS
DT24294	Mount, Coupler Plate, CDS
5105106	Brace, ODS, Multi Coupler Plate, CDS

Affected Units

All CDS Link Tilt Assemblies simultaneously equipped with Single Joints Links Stabilizer Kit #5104015 and Coupler Plate Mount #DT24294.

Recommended Steps

1. Disassemble Single Joints Links Stabilizer Kit #5104015 from the CDS Link Tilt Assembly.

2. Disassemble the Multi Coupler Plate #H16763 (1), Mount #DT24294 (2) and Guard #16062 (3) from the CDS Link Tilt Assembly (ODS side only):

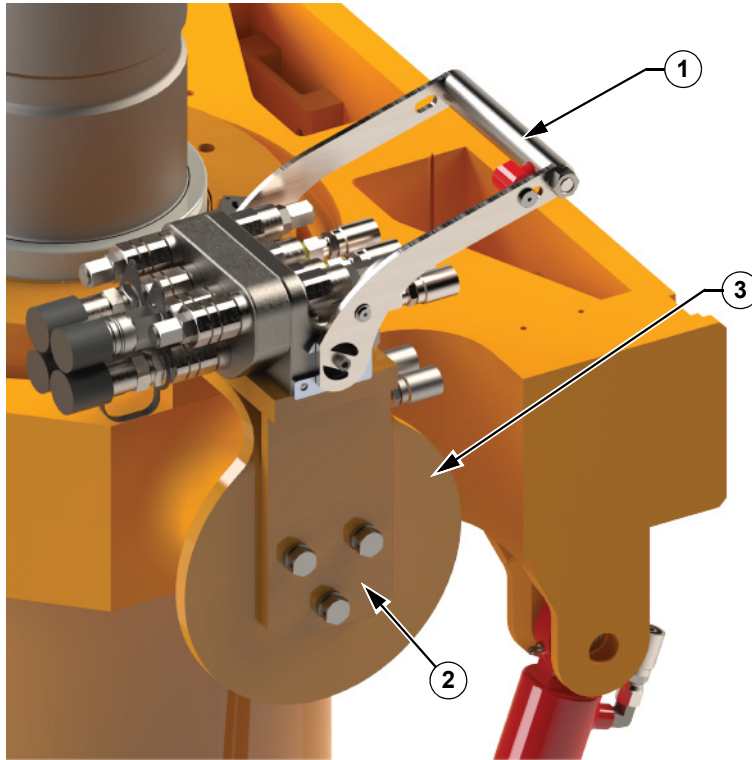

Figure 1: Guard, Mount and Multi Coupler View

3. Discard the #DT24294 (2), ODS Guard #16062 (3) and their fasteners.



Model: CDS

Serial #: N/A

Sep. 12, 2024

4. Install Brace #5105106 (4) with fasteners – top side only.
- 2x Washer, Lock, Helical Spring, 1/2", Alloy, Pld #5881 (5).
 - 2X Screw, Cap, Hex Hd, 1/2"-13UNCx3-1/2", Gr8, Pld, Dr Hd #16327 (6).
 - Apply Lock Wire.

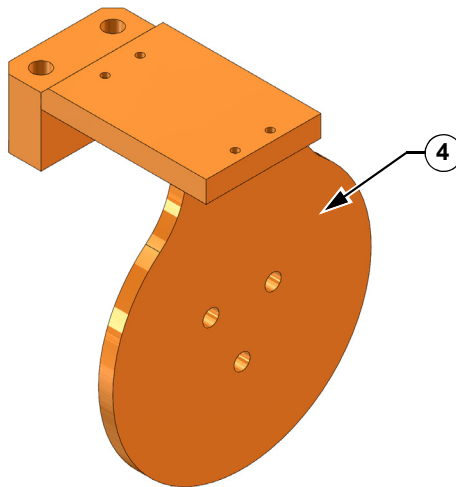

Figure 2: Brace

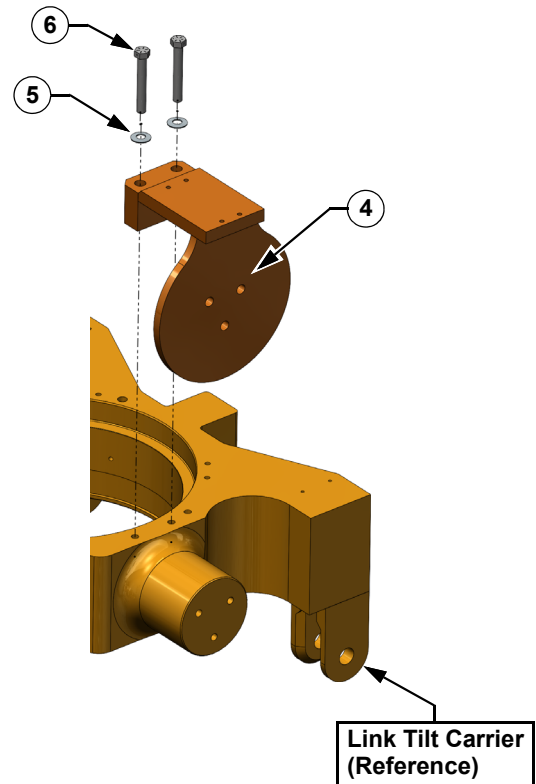

Figure 3: Brace installation – Top side

NOTICE

Trunnion (7) and Fasteners (8, 9) from Stabilizer Kit #5104015 are necessary to finalize Brace's installation (Step 6 on page 4).

5. Install the H16763 Multi Coupler Plate (1) to the Brace (4) by re-using its fasteners:
 - 4x Lockwasher, 1/2 Nord-Lock #LW-0500-NL.
 - 4X CAPSCR, HEX SOC HD, 5/16-18UNC x 2.50, W #SH-0312NC-0250-W.
 - Apply Lock Wire.
6. Re-install Single Joints Links Stabilizer Kit to the CDS Link Tilt Assembly as per #5104015 Assembly Drawing:

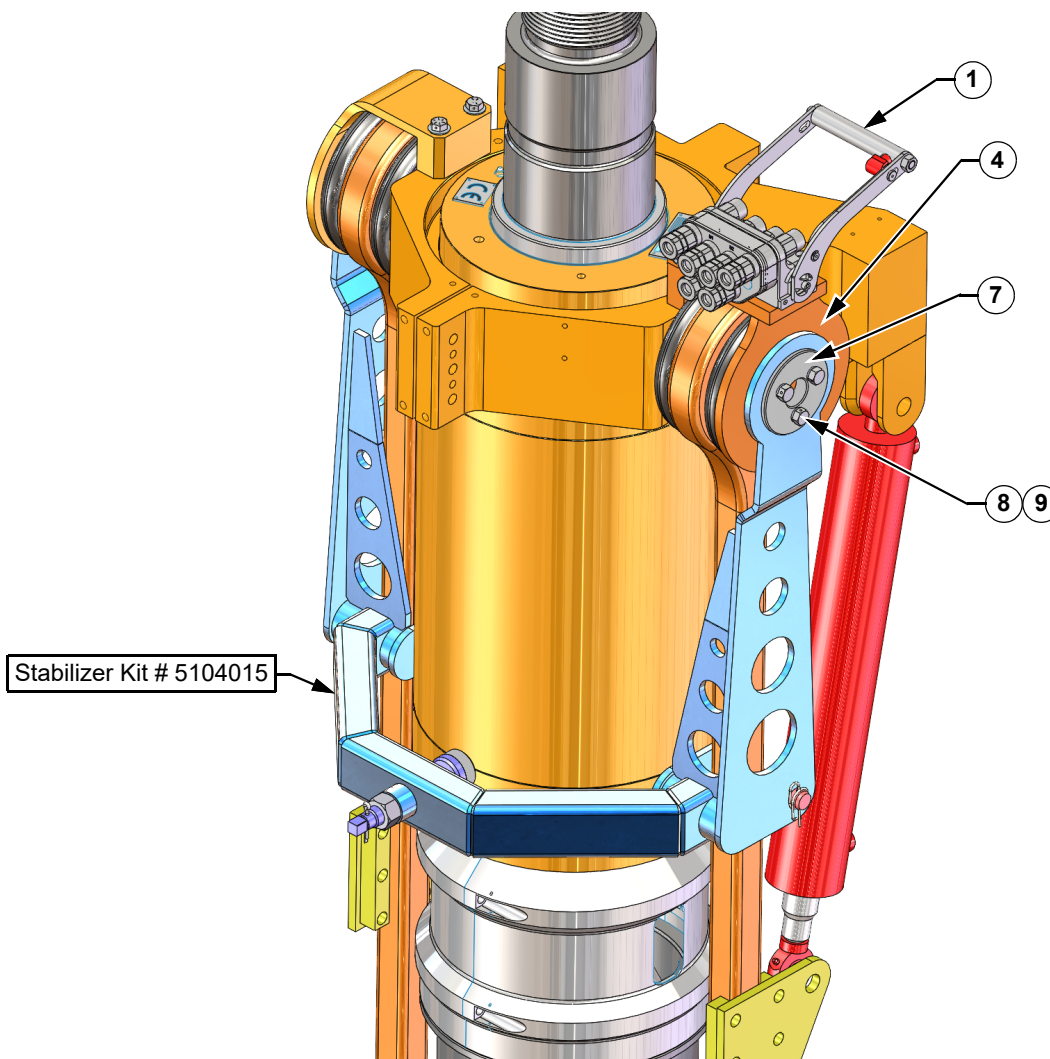

Figure 4: Brace, Multi Coupler and Stabilizer Kit view



IMPORTANT

Ensure the screws used to mount Trunnions #5104016 are compliant with 9012 Screw, Cap, Hex Hd, 1/2"-13UNC x 2-1/4", Gr 8, Pld, Dr Hd, torqued to 80 ft-lb and lock wired.